

	A Cabinet Width	B Cabinet Depth	C Backboard Width	D Working Depth	E Cabinet Weight	F Plinth Weight	G Plinth Opening	H Plinth Fixings
RB1250	1250.0	430.0	1195.0	408.0	82.0Kg	11.0Kg	1100x350	1200x330
RB1550	1550.0	430.0	1495.0	408.0	90.0Kg	12.0Kg	1400x350	1500x330

Backboard has a Maximum Permissible Load of 225 kg/M²

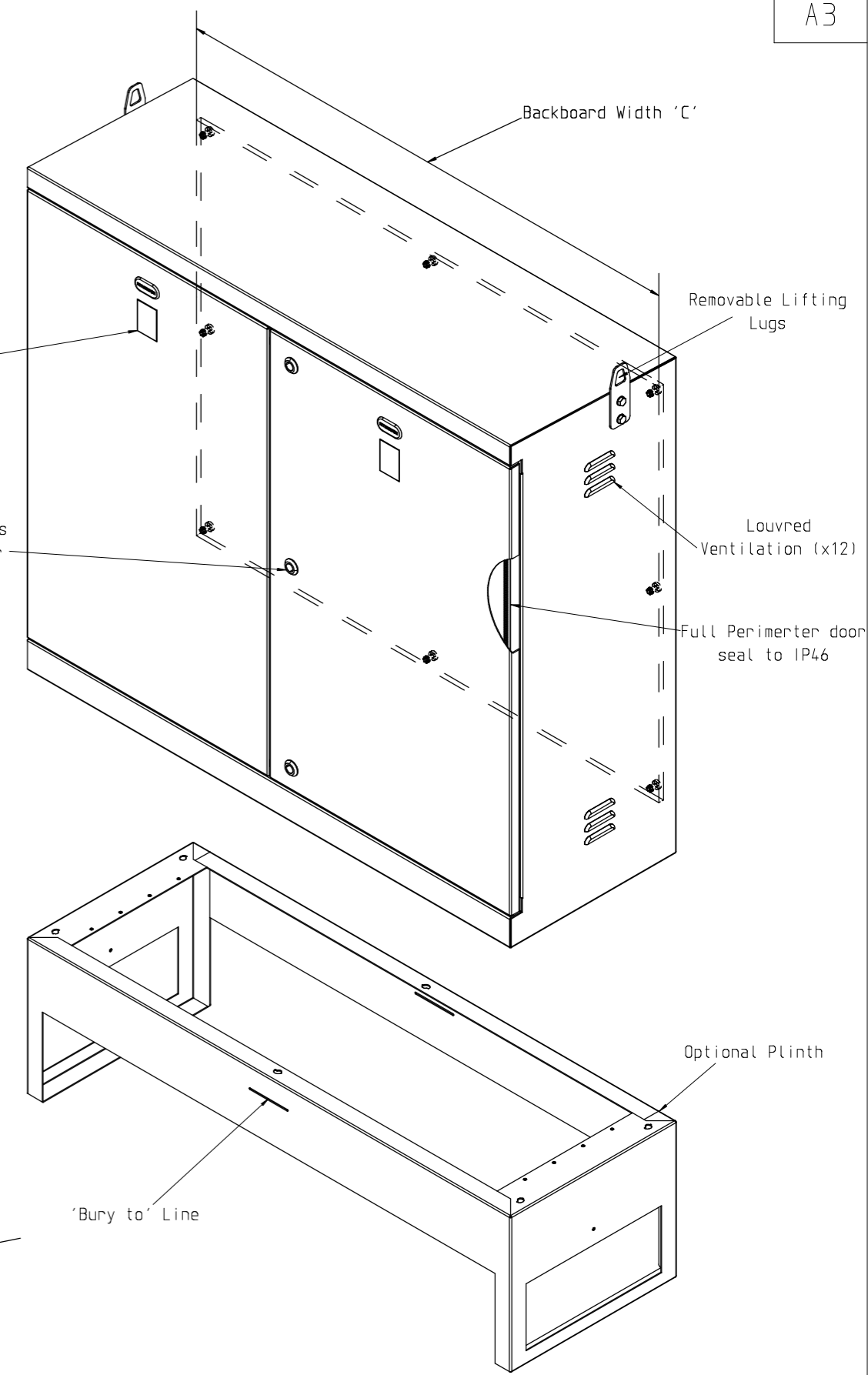
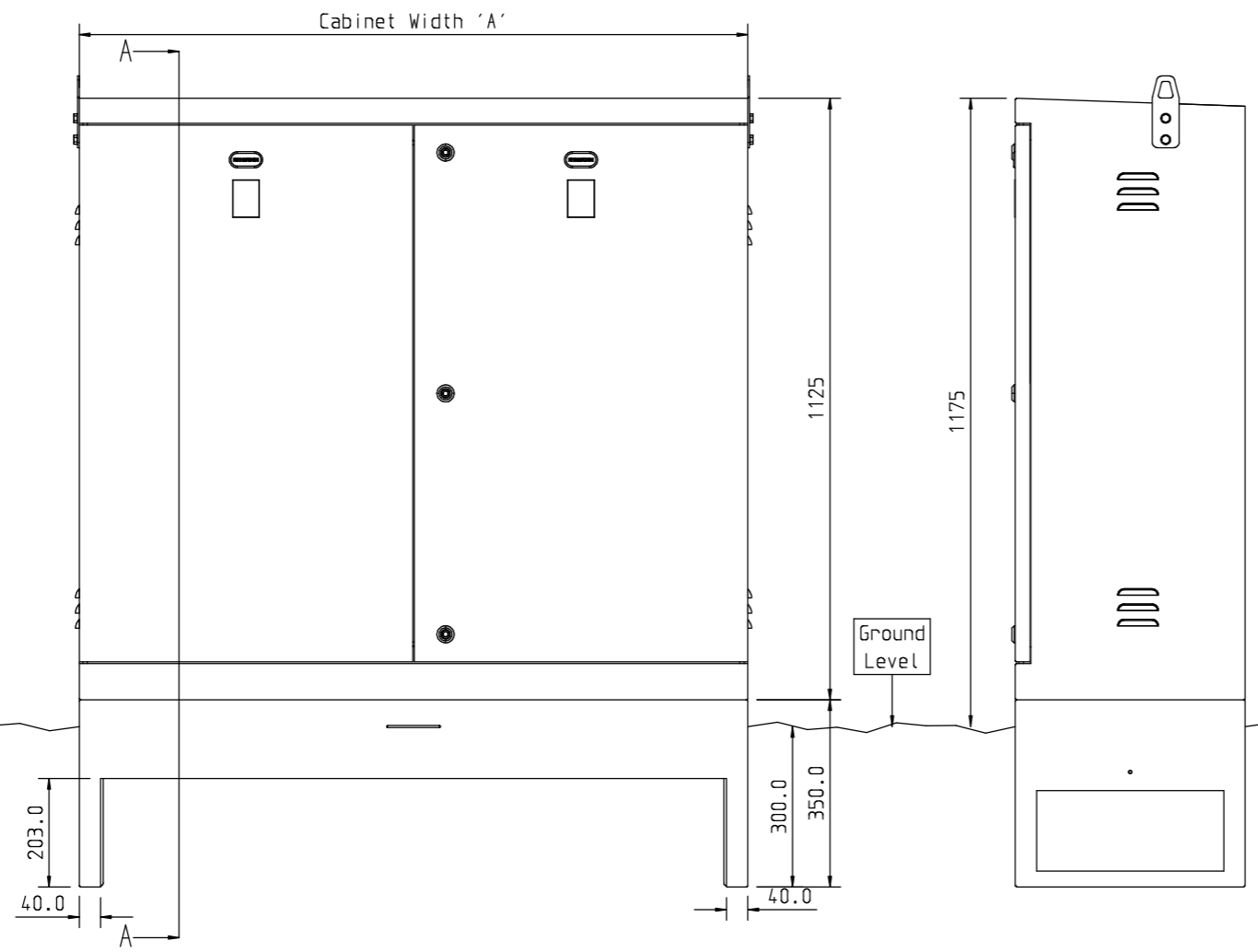
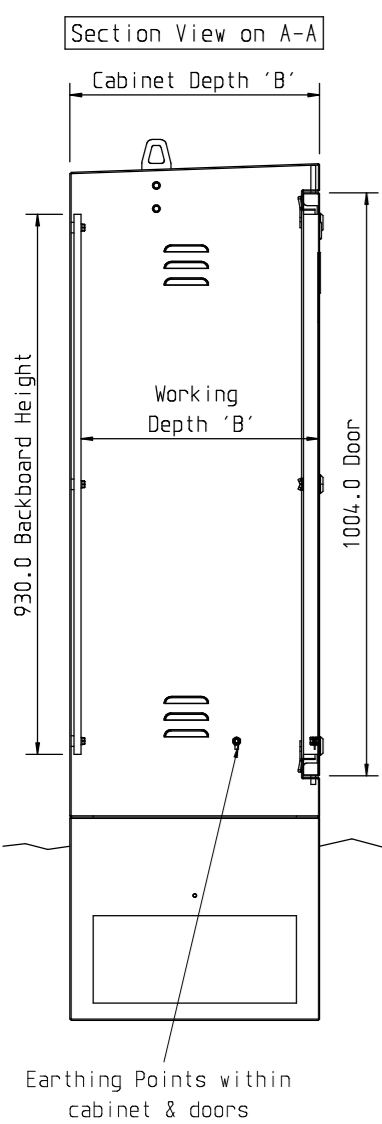
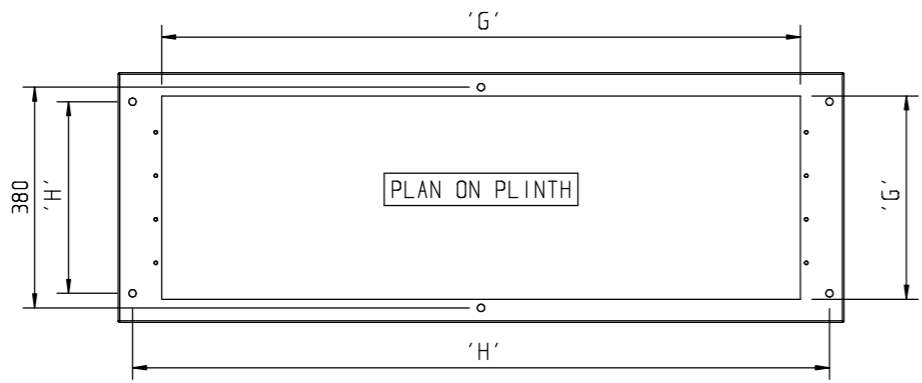

DRAWN	Josh Eastham	DATE	26 . 06 . 2018
CHECKED	Mark Blease	DATE	26 . 06 . 2018
APPROVED	Mark Blease	DATE	26 . 06 . 2018

A	28/9/20	1265	MAB
ISSUE	DATE	MOD. NO.	DRN



TOLERANCES
 WHOLE NUMBERS +/- 0.5
 1 DECIMAL PLACE +/- 0.2
 HOLES +/- 0.15
 UNLESS OTHERWISE STATED
 ALL OUTSIDE SIZES

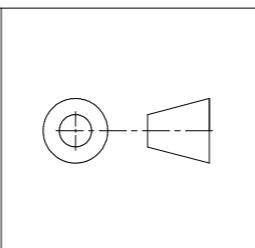

MATERIAL
 2mm Stainless Steel

FINISH
 Powder Coated

TITLE RB Double Door Cabinet General Arrangement			
SCALE	DRAWING NO.	[SHEET]	ISSUE
NTS	S 9174	9	A